

1. Referring to the map of the township below, please indicate in which numbered area you live or own property.

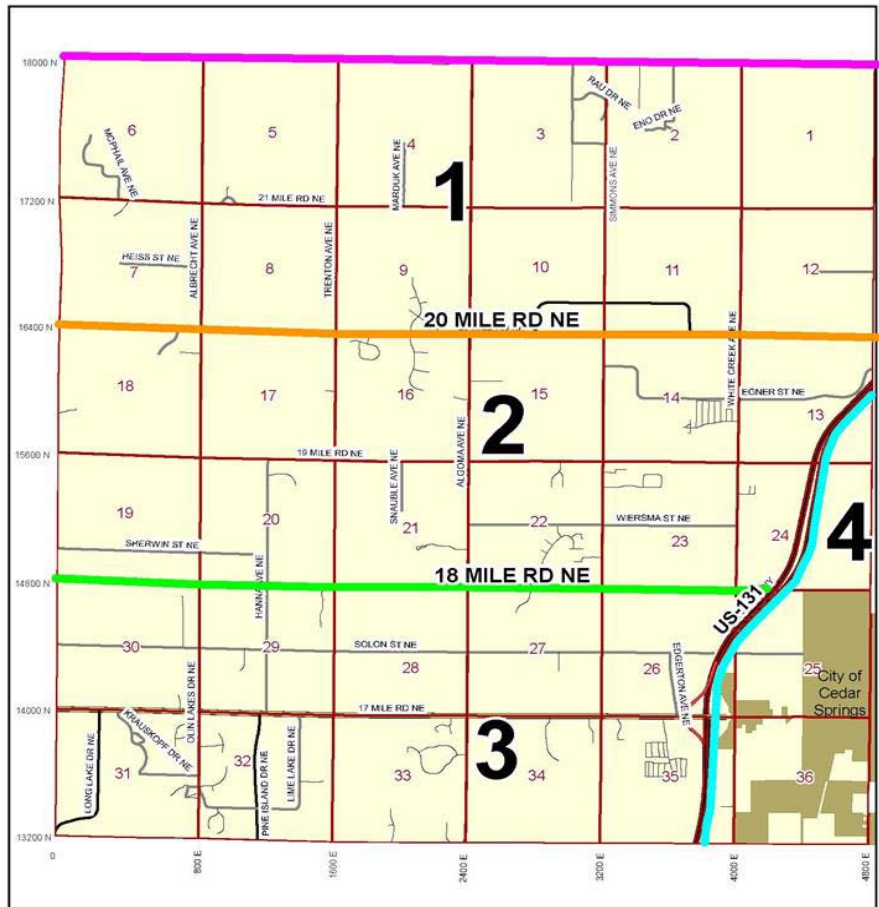

- Area 1
- Area 2
- Area 3
- Area 4

2. What best describes the type of property you own in Solon Township? Check all that apply.

- Vacant land
- Primary residence
- Secondary residence
- Commercial business
- Rental housing
- Agricultural
- Other (Please Specify) _____

3. What size parcel(s) do you own in Solon Township? Check all that apply.
- acre or less
 - 1.1 to 5.0 acres
 - 5.1 to 10 acres
 - 10.1 to 20 acres
 - 20.1 to 40 acres
 - 40.1 or more
4. How long have you owned property in the township? Select only one.
- 5 years or less
 - 6 to 10 years
 - 11 to 30 years
 - 31 years or more
5. Do you generally support the division of large parcels of land into smaller parcels for single-family dwellings?
- Yes
 - No
6. Currently, how is your drinking water quality?
- Poor
 - Fair
 - Good
7. Currently, how does your drain field function?
- Poor
 - Fair
 - Good
8. In your opinion, what is the primary reason residents locate in Solon Township? Select only one.
- Rural character
 - Proximity to US-131
 - Low taxes
 - Proximity to Grand Rapids
 - Proximity to Lake Michigan

- Proximity to Cedar Springs
- Other (Please Specify) _____

9. Do you ride a bicycle for recreation?

- Yes
- No

10. Do you use the Rogue River State Game Area?

- Yes
- No

11. Would you utilize the proposed Velzy Park at the Township Hall property (ballfields, trails, farmer's market, etc.)?

- Yes
- No

12. Do you utilize Long Lake Park?

- Yes
- No

13. Would you utilize the proposed North Country National Scenic Trail (hiking trail)?

- Yes
- No

14. Do you utilize the White Pine Trail (all-purpose trail)?

- Yes
- No

15. Should the Township do more to create **outdoor** recreational opportunities for any of the following? Select all that apply.

- Playgrounds
- Lake and creek access
- Biking and hiking trails
- Camping
- Other (Please Specify) _____

16. Do you think the Township should do more to create **traditional** recreational opportunities such as tennis, basketball, play equipment, ball fields, etc...

Yes

No

17. Should the Township acquire land for future parks and playgrounds?

Yes

No

18. Would you be willing to pay a small millage to provide better recreational opportunities?

Yes

No

19. Presently, the " AR - Agricultural Residential Zoning District" has a minimum lot size of 1.0 acres. Do you think it should be:

Increased

Decreased

Stay the same

20. Presently, the "R-1 - Residential Zoning District" has a minimum lot size of 1 acre. Do you think it should be:

Increased

Decreased

Stay the same

21. Presently, the "R-3 - Lake Front Residential District" has a minimum lot size of 15,000 square feet. Do you think it should be:

Increased

Decreased

Stay the same

22. Do you support increased controls on development to protect water quality in rivers and streams?

Yes

No

23. Which natural features in Solon Township are important to you? Select all that apply.

- Public access to Township Creeks
- Water quality of lakes and creeks
- Protection of drinking water supply
- Access to Lakes
- Other (Please Specify) _____

24. If the township were to consider the creation of a new zoning district called "Low Density Residential" or "Rural Estates", what minimum size lots would you like to see?

- Less than 1 acre
- 1 to 3 acres
- 3 to 5 acres
- 5 to 10 acres

25. In the area where you live, should the following types of new housing be encouraged?

- Single-family homes on 5 acres lots or larger
- Single-family homes on one acre lots or smaller
- Apartments, duplexes or attached condos
- Both housing and commercial development together
- Single-family homes on lots 1 to 5 acres

26. In the area where you live, what best describes your preference for future residential development? Select all that apply.

- Small lots with houses close to the street
- Large wooded lots
- Connected streets rather than dead-ends
- Dead-end private streets with few houses
- Smaller clustered lots with some open space
- Pedestrian trails, sidewalks, bikeways and paths
- Houses set back a long way from the road
- Mixed residential and commercial

27. Would you be in favor of having a gas station or convenience store near where you live?

Yes

No

28. Would you like to see any of the following types of senior citizen housing in the township?

Select all that apply.

Assisted Living

Senior Apartments

Nursing Home

Retirement Community

Other (Please Specify) _____

29. Housing developments with lots clustered to preserve open space, are a good way to protect the rural feel of the township.

Agree

Disagree

30. Accessory buildings should be limited in number and size according to the size of the lot.

Agree

Disagree

31. Would you like to see more aggressive enforcement of zoning violations?

Yes

No

32. Do you have any other comments?